



Main Features:-

- ◆ "Y" strainer
- ◆ DN40 to DN300 PN16
- ◆ Cast Iron EN-GJL-250 (GG-25)
- ◆ Working Temperature -10 to $+120^{\circ}\text{C}$ *
- ◆ Screen made of Stainless Steel AISI 304

*Temperature and pressure determined by valve body, seat etc.

Suitable Applications & Approvals:



HVAC



OIL



GAS



INDUSTRY



SERIES: 80244

MANUFACTURER: **GENEBRE**

VALVE MATERIALS & DIMENSIONS

ITEM	SECTION	MATERIAL	ADDITIONAL INFO / OPTIONS
1	Body	Cast Iron EN-GJL-250	Epoxy coated
2	Cover	Cast Iron EN-GJL-250	Epoxy coated
3	Gasket	Graphite	J80244
4	Mesh	SS AISI304	T2458
5	Bolt	Steel	Zn. Plated
6	Plug	Steel	Zn. Plated

REF	SIZE	D	A	L	P	D3	Plug	PN	Kg
80244-08	1 1/2"	150	110	200	2.5	1.5	G1/2"	16	7
80244-09	2"	165	130	230	2.5	1.5	G1/2"	16	9.5
80244-10	2 1/2"	185	145	290	2.5	1.5	G1/2"	16	12.5
80244-11	3"	200	170	310	2.5	1.5	G1/2"	16	16
80244-12	4"	220	200	350	2.5	1.5	G1/2"	16	23
80244-13	5"	250	240	400	2.5	1.5	G1/2"	16	31
80244-14	6"	285	275	480	2.5	1.5	G1/2"	16	45
80244-16	8"	340	350	600	3	2	G3/4"	16	85
80244-18	10"	405	430	730	3	2	G3/4"	16	134
80244-20	12"	460	540	850	3	2	G3/4"	16	184

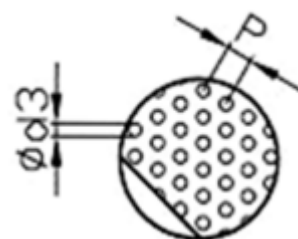
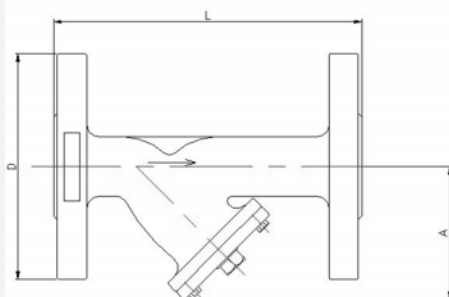
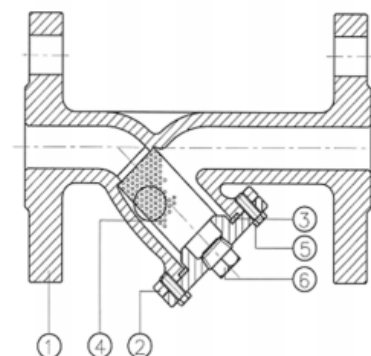



Genebre are a global brand of industrial valves with large stocks held for fast delivery on various type of valves, sizes, end connections and materials.

SERIES: 80244

REF	SIZE	Kv
80244-08	1 1/2"	37.3
80244-09	2"	62.4
80244-10	2 1/2"	95.4
80244-11	3"	138.5
80244-12	4"	224.4
80244-13	5"	371.2
80244-14	6"	425.4
80244-16	8"	698.2
80244-18	10"	1204
80244-20	12"	1852

TORQUE :

- The liquid listed in the table are initial breakaway torques, taken with liquids and lubricant media.

- Please regard these as approximate values, as the objective value on different factors like pressure, medium, rubber,

KV VALUES:

- The Kv values (M3 per hour) is the flow of water at a temperature of 5C to 30C (41F to 86F) at p of 1 bar

- For further information, please email sales@allvalves.co.uk

PRESSURE AND TEMPERATURE CHART

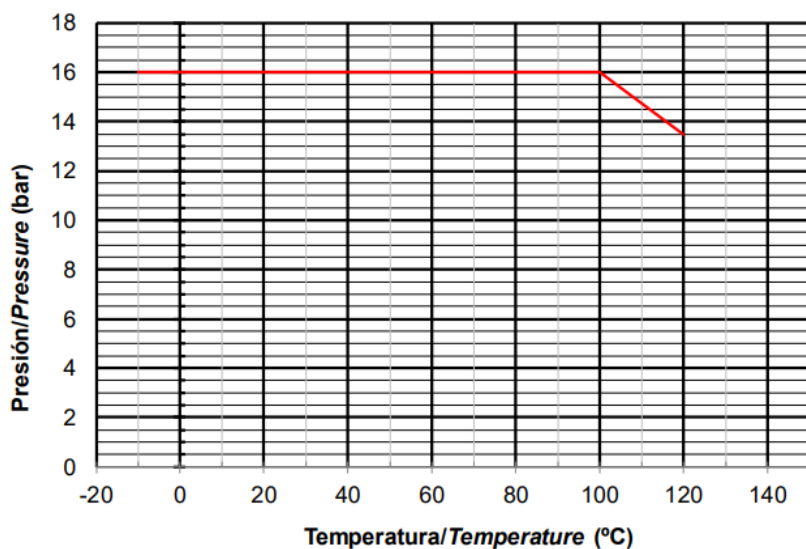

GENEBRE

Genebre is a leading company and world reference in fluid control and high-quality taps. They control all the creation processes, responding to the specific needs of each market: from the initial concept and design of the product to the production and commercialization.

In the Industrial line of Genebre products you will find a wide range of industrial valves and their accessories, sanitary line valves, automated valves and control valves, stainless steel fittings, different elements for industrial instrumentation and all spare parts for valves sphere.

ALL VALVES

Offering a full range of actuated valve packages, manual valve range, pipe fittings and pumps, we have a product for all your requirements. As an ISO 9001-2015 Quality Approved and certified company, All Valves offer a quality service from pre-sale to post sale. Shipping millions of pounds in value of manual valve and actuated valve packages all over the world since its formation, All Valves are a trusted valve and actuator supplier to many companies all over the world. Working with the leading brands in most industries.

